

PRIMARY DUCT WITH COMMUNICATION

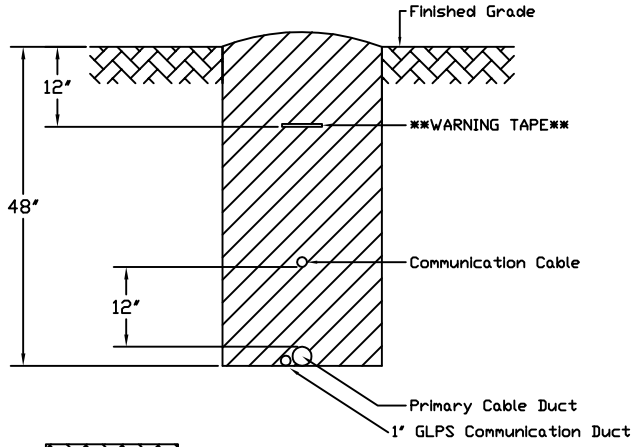

UNDISTURBED EARTH
 COMPACTED BACKFILL

*NOTE: PRIMARY CABLE CONDUITS SHALL BE INSTALLED 48" BELOW FINISHED GRADE.
 *NOTE: 12" (MEASURED VERTICALLY) OF WELL TAMPED EARTH SHALL SEPARATE GLPS PRIMARY CONDUITS AND COMMUNICATION CABLES.

PRIMARY/SECONDARY DUCT WITH COMMUNICATION

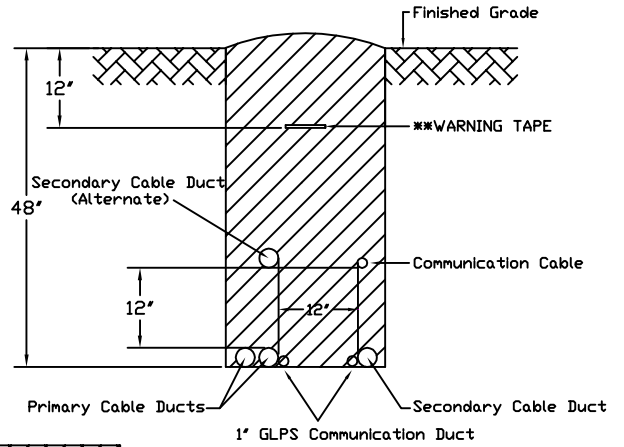

UNDISTURBED EARTH
 COMPACTED BACKFILL

*NOTE: PRIMARY CABLE CONDUITS SHALL BE INSTALLED 48" BELOW FINISHED GRADE.
 *NOTE: 12" (MEASURED VERTICALLY) OF WELL TAMPED EARTH SHALL SEPARATE GLPS PRIMARY CONDUITS AND COMMUNICATION CABLES. 12" (MEASURED HORIZONTIALLY) OF WELL TAMPED EARTH SHALL SEPARATE GLPS SECONDARY/SERVICE CONDUITS FROM COMMUNICATION CABLES.

SERVICE/SECONDARY DUCT WITH COMMUNICATION

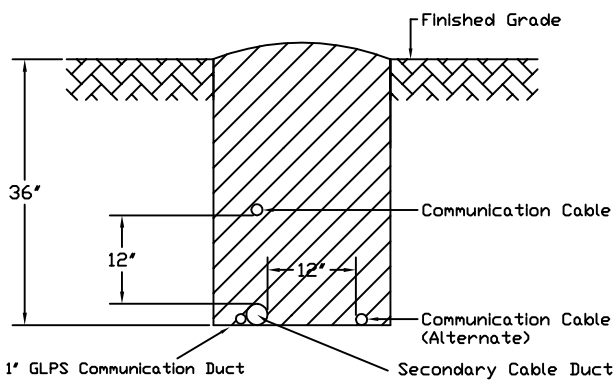

UNDISTURBED EARTH
 COMPACTED BACKFILL

*NOTE: SECONDARY / SERVICE DUCTS SHALL BE INSTALLED 36" BELOW FINISHED GRADE.
 *NOTE: 12" (MEASURED VERTICALLY OR HORIZONTIALLY) OF WELL TAMPED EARTH SHALL SEPARATE GLPS SECONDARY CONDUITS AND COMMUNICATION CABLES.

CROSSINGS

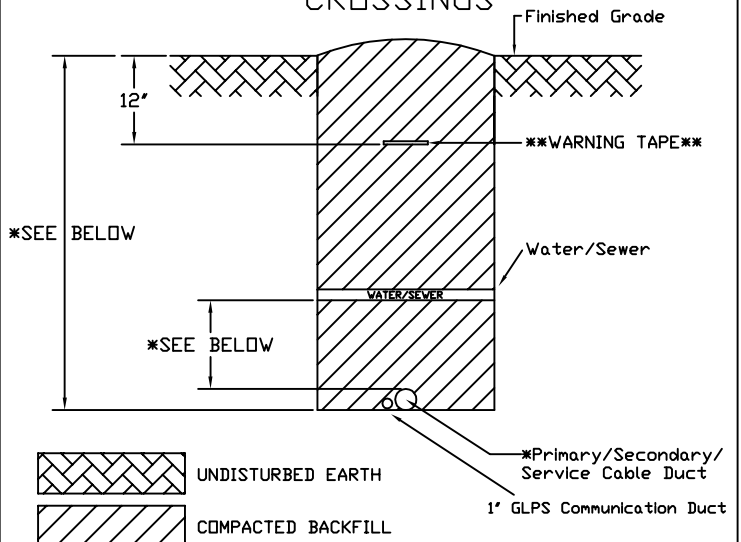

UNDISTURBED EARTH
 COMPACTED BACKFILL

*NOTE: MINIMUM PRIMARY CONDUIT DEPTH- 48"
 MINIMUM SECONDARY / SERVICE CONDUIT DEPTH- 36"
 *NOTE: A MINIMUM OF 12" (MEASURED VERTICALLY) OF WELL TAMPED EARTH SHALL SEPARATE GLPS CONDUITS AND OTHER UTILITIES SUCH AS WATER AND SEWER.
 *NOTE: WHEN SUCH A CROSSING IS NECESSARY, GLPS CONDUIT SHOULD BE AT THE LOWER LEVEL IN DITCH.

INSTANCES WHEN MINIMUM DEPTHS CANNOT BE ACHIEVED, DUCT TO BE CONCRETE ENCASED- 7-1/2" ON CENTER, MINIMUM 3" AROUND DUCT

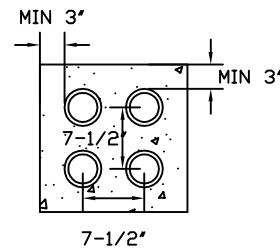
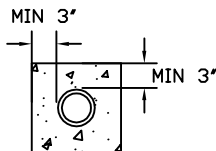

DWN	SWB	NO	DATE	REVISION
DATE	10-13-97	1	05-22	1" COMM DUCT
CHK				
DATE				
APP		SCALE	NONE	
DATE		SHT#	1 OF 1	

SUBJECT
DETAIL
TYPICAL JOINT TRENCH

DWG #
JT1
ENGINEERING DEPT.